

HAND DRYER



USER MANUAL

CHARACTERISTIC

Touch free, just put hands below the wind spout within 15cm.

To avoid power wasting due to continuous error induction by objects in the detection zone, it has been set with the function of power on over 0.5second.

Design with 105 centigrade thermal cut off.

Drying time is 40-50seconds

High R.P.M. with low noise and dryer hand quickly.

Easy to mount it and installation, instructions included.

Curvaceous and smooth.

INSTALLATION

The machine should be fixed on the firm and fastened wall.

Do not install the dryer on the wall which raw material is flammable.

Do not jam the wind mouth.

Please cut off the power immediately when the dryer occurs breakdown and please try to contact the seller for more information.

Forbid to wipe the outer shell with caustic liquid, such as banana water, alcohol.

Do not dismantle the dryer except a professional.

INSTALLATION DIAGRAM

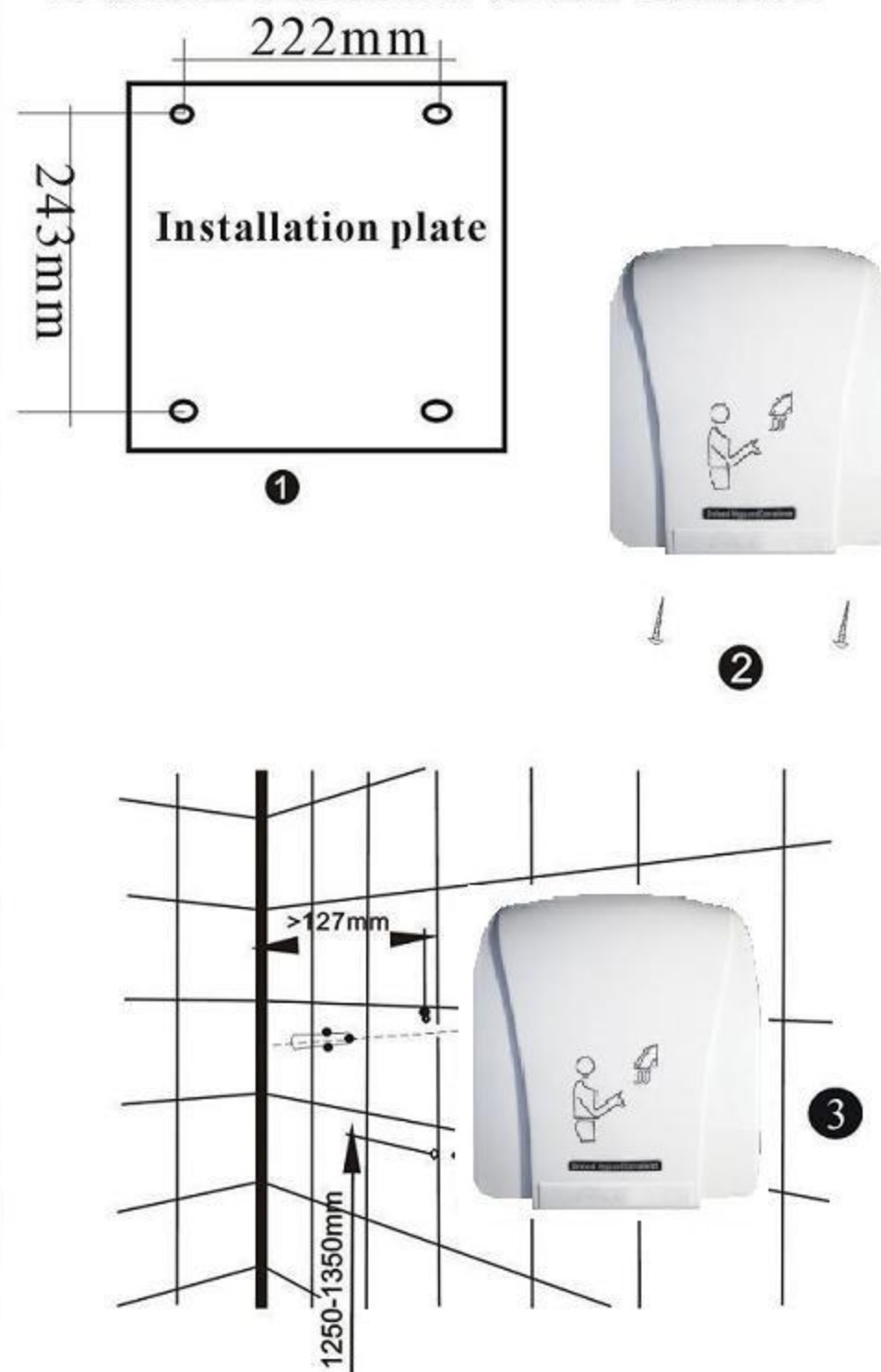

NOTICE

Drill four holes on the wall as diagram 1 and bury the expansion tube into the hole.

Loose the screw at the hand dryer bottom as diagram 2.

Take the dryer front cover and then fix the machine on the wall by the enclosed screw. Put back the cover and fasten the screw.

Connect the power plug to the electrical power.

TECHNICAL DATA

Voltage	AC220~230V/50 Hz
Rated Power	1500W
Sensor Range	50~150MM
Wind Speed	>10M/S
Air Temperature	> 54°C
Net Weight	2.4 KGS
Demensions	W280 x D240 x H220
Waterproof Protect	IPx1
Electric Shock Protect	Class II

POWER DIAGRAM

